



# DS1600



## OPERATION MANUAL

**IMPORTANT SAFETY INSTRUCTIONS PERTAINING TO  
A RISK OF FIRE, ELECTRIC SHOCK, OR INJURY TO PERSONS.**

**SAVE THESE INSTRUCTIONS**

**READ ALL INSTRUCTIONS BEFORE USING THIS APPLIANCE.**

**FOR HOME USE ONLY, USE ONLY AS INTENDED.**

**KEEP AWAY FROM CHILDREN, NOT A TOY.**



**Intertek**

3135426

MADE IN CHINA

Distributed by:  
Dynamic Solutions Worldwide, LLC  
12247 W. Fairview Ave.  
Milwaukee, WI 53226  
EPA Est. No. 091481-CHN-001

### SUPPORT

[support@dynasteam.com](mailto:support@dynasteam.com)

1-877-403-8727

[www.dynasteam.com](http://www.dynasteam.com)

WARNING

RISK OF INJURY

- Steam is extremely hot and parts of the appliance may become dangerously hot on contact!
- Never touch or point steam at yourself or others!
- When using electric appliances, precautions should always be followed, including the following:
- DynaSteam is not a toy and should never be operated by children.
  - Steam temperatures exceed 300°F, never direct steam at people, animals or electrical devices.
  - The DynaSteam is designed for household use only.
  - Never operate without water in tank.
  - Do not overfill the water tank. The DynaSteam maximum capacity is 1.5 quarts of water (6 cups). Over filling of the water tank may cause damage or injury.
  - Never turn DynaSteam over or tilt more than 45° when it is switched on or if still producing steam.
  - Do not operate DynaSteam for more than 1 hour at a time.
  - Do not expose to rain or immerse the DynaSteam, Cord, or Plug in water or any other liquid.
  - No user serviceable parts.
  - Do not attempt to make any repairs yourself. The DynaSteam should only be serviced by qualified electricians. For repairs and assistance, contact the DynaSteam team at (877) 403-8727
  - Keep hair, loose clothing, fingers, feet and all parts of body away from the jet of steam.
  - Do not operate DynaSteam in bare feet or when wearing open toe shoes or sandals.
  - Never operate without the fill cap screwed tightly in place.
  - Do not pull or carry DynaSteam by the cord, use cord as a handle, close door on cord or pull cord around sharp edges or corners.
  - Keep cords away from heated surfaces.
  - Never leave DynaSteam unattended while plugged in.
  - Always unplug DynaSteam when not in use. Turn all controls off before unplugging.
  - Do not unplug by pulling cord. Always grasp the plug, not the cord.
  - Never operate with a damaged cord.
  - Never handle plug or appliance with wet hands.
  - Never use DynaSteam to clean electrical devices.

- Never direct the steam or water towards equipment containing electrical components such as oven interiors.
  - Do Not store or operate near flammable materials.
  - Do Not place DynaSteam on or beneath insulating materials such as blankets, towels, or papers.
  - Always store DynaSteam in a dry location.
  - Do not expose DynaSteam to freezing temperatures.
  - Use only original DynaSteam accessories.
  - Check the DynaSteam and power cords for worn parts and irregularities before using. Do not power on the DynaSteam if it is damaged.
  - Do not clean DynaSteam with a water spray or the like.
  - Store DynaSteam indoors when not in use - out of the reach of children.
  - Not to be used for space heating.

EXTENSION CORDS

- Extension cords may be used if care is exercised in their use. If an extension cord is used:
- The marked electrical rating of the detachable power-supply cord or extension cord should be at least as great as the electrical rating of the appliance;
  - If the appliance is of the grounded type, the extension cord should be a grounding type 3-wire cord; and
  - The longer cord should be arranged so that it will not drape over the countertop or tabletop where it can be tripped over, snagged, or pulled on unintentionally (especially by children).
  - Outdoor extension cords should be used with outdoor use products and are surface marked with suffix letter `W` and with a tag stating Suitable for Use with Outdoor Appliances.
  - Extension cords should be kept dry and off the ground.
  - Use only three-prong grounding extension cords in good condition and listed as UL, ETL, or CSA approved. For lengths greater than 18 feet, use no. 16 AWG extension cords. Undersized cords may result in loss of power and overheating.

NOT USER SERVICEABLE

Repair requires extreme care and knowledge of the system, and should only be done by qualified service personnel. Use only DynaSteam authorized replacement parts and accessories.

For repairs and assistance, contact the DynaSteam team at (877) 403-8727



CAUTION

If an excessive amount of steam is coming from the fill cap, turn power off and unplug immediately. Contact qualified technician for service.



HOT STEAM AND PARTS

May Cause Severe Skin Burns And Property Damage. Temperatures Exceed 300° F



ELECTRICAL SHOCK

May Cause Severe Injury And Property Damage.



FIRE

May Cause Severe Injury And Property Damage.

ELECTRICAL GROUNDING

This product must be grounded, improper use may result in electrical shock. The DynaSteam is equipped with a cord containing a grounding wire and grounding plug. The plug must be used only in outlets that are grounded in accordance with all local codes and ordinances.

OUTLETS

The DynaSteam is intended for use with 120 volt circuit with grounding receptacle. Use only with grounded outlets with matching plug configuration. Do not use electrical adaptors.

WATER

Maximum capacity is 1.5 quarts (6 cups) of water. Do not overfill. Length of steam is approximately 35 minutes under normal use. Heating time is approximately 10 minutes for a full tank.

CALIFORNIA PROP 65

The electrical wire coating used in this product contains lead, a chemical known by the State of California to cause birth defects or other reproductive harm. Wash hands after contact.

STORAGE

Empty water after each use. Do not store DynaSteam with water. Empty, clean and dry before storing. Do not expose DynaSteam to freezing temperatures.

FABRICS & FINISHES

CAUTION: Some fabrics and finishes are not compatible with steam. Do not use steam on leather, waxed floors, synthetic fabric, velvet, and other delicate materials. When using steam, always refer to the manufacturers guidelines and test in a small discrete area first.

GLASS/MIRRORS

WARNING: Never apply steam to glass or mirror surfaces with a temperature lower than 32° F. Thermal shock due to extreme temperature differences can shatter glass and mirrors on contact.

REFILLING

Before refilling, turn power off and unplug DynaSteam. Ensure all steam is released by locking steam trigger in ON position. Always allow DynaSteam to cool for 10 minutes before adding water.



1

Remove Pressure Cap By Twisting In A Counter Clockwise Direction



2

Fill Tank With Water Using The Included Funnel And Measuring Cup. Maximum Capacity, 6 Cups (48oz), Do Not Overfill.



3

Replace Pressure Cap By Twisting In A Clockwise Direction Until Tightly Sealed.



CAUTION: Failure to follow all precautions may result in injuries from escaping steam if pressure cap is removed prematurely. Metal parts may be extremely hot, avoid contact with skin. May cause skin burns.

NOTE: Pressure cap will not unscrew until pressure has been reduced.

SPECIFICATIONS

Steam Chamber-----	Stainless Steel
Max Temp-----	311°F
Max Pressure -----	65 PSI
Water Capacity -----	6 cups /48 oz
Power Consumption -----	1600 W
Amperage-----	13.33 A
Net Weight -----	8.11lbs

GETTING ACQUAINTED

1

Handle Operation.  
Locate the Steam Trigger and Trigger Lock on the Steam Handle. The Lock has two positions, OFF/LOCK, and ON. Press the front of the Trigger Lock to lock, press the back of the Trigger Lock to unlock.

2

Releasing Steam.  
When the Pressure Gauge enters the red zone, your DynaSteam is ready to go (maximum pressure = 65 PSI). Press Green Lock to the ON position and pull the Steam Trigger to release a burst of steam. Release trigger to stop steam.

"LOCKED OFF" POSITION

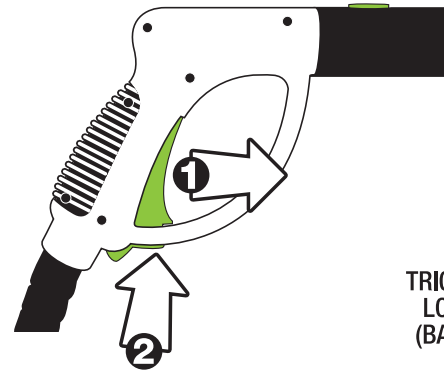

ON/OPERATING POSITION

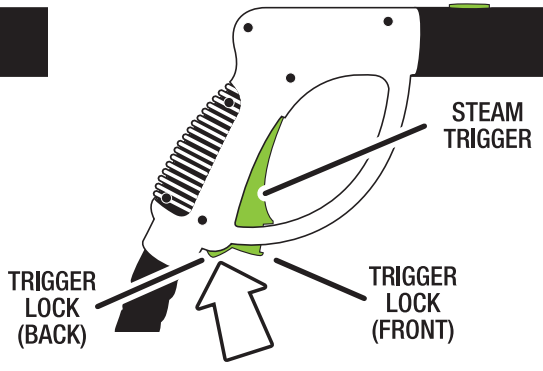

CONTINUOUS "LOCKED ON" POSITION

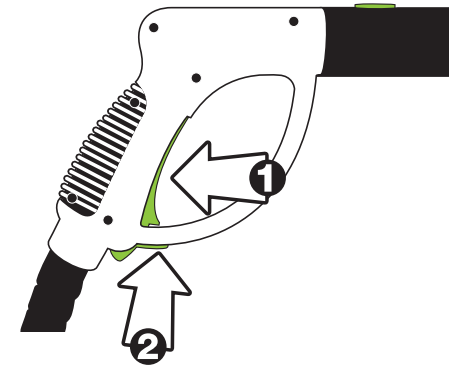

STEAM THE WEEDS AWAY™



3

Continuous Steam operation.  
To release steam for an extended period without holding the trigger, pull trigger then press the green lock in the OFF/LOCK position. This will lock the valve open and release a continuous stream of steam until the ON button is pushed again.

Continuous steam is only recommended to release excess steam before emptying contents.

4

After Using.  
Lock trigger in OFF position to prevent accidental operation. With trigger in open position depress lock switch.

USING DYNASTEAM FOR THE FIRST TIME

- 1) Make sure DynaSteam is unplugged.
- 2) Unscrew Pressure Cap (5) by turning anti-clockwise.
- 3) Using the measuring cup and funnel, fill the machine with up to 6 cups of water. (This will provide approximately 35 minutes of steam)
- 4) Replace the pressure cap by turning clockwise and fasten tightly.
- 5) Attach the accessory or tool you plan to use.
- 6) Plug the machine in and switch on. Two lights will illuminate. The red switch light (14) is the power indicator. The orange heat light (15) indicates that the machine is building up steam pressure. When the machine is first turned on this light will illuminate and can take up to 10 minutes to reach the correct pressure level depending on the amount of water in the tank. On the pressure gauge (6), the max pressure will be approximately 65 PSI.

The orange heat light indicator will alternate on and off as the steam pressure is regulated. Releasing the steam trigger will allow the steam pressure to build up.

**Steaming while the pressure gauge is in the red zone will produce good results.** If Pressure falls out of the red zone, pause steaming to regain the maximum pressure. The steam pressure should build up again in less than 40 seconds.

If the steam trigger is pressed under low pressure, only insufficient low temperature steam or hot water may come out.



FOR BEST RESULTS

Apply Steam While Weeds Are Actively Growing In Sunny Dry Conditions.

1. LOCATE WEED

TRS - Triple Root Spike



2. APPLY STEAM



3. WEEDS DIE IN 24-48 HOURS



Speed Weed Cone



Precision Power Jet





FREQUENTLY ASKED QUESTIONS

Why does water come out of the nozzle?

The DynaSteam generates a large amount of steam which can condense into water in the hose, tools, or nozzle and accumulate after a period of cooling/non-use. A small amount of water will be discharged before steam resumes. This is normal, and the excess water can be quickly released into a bucket if the water is unwanted.

No Steam Is Coming Out?

Check hose for any kinks or twists and untwist hose if necessary.  
Check to see if you have run out of water. (Pressure gauge will show zero pressure)

I cannot remove the fill cap?

Make sure the DynaSteam is fully de-pressurized. The pressure cap is designed not to be able to be removed while under pressure. Release all remaining steam in tank by squeezing the Steam Release Trigger. Trigger can locked open by engaging the Trigger Lock in the ON position. After pressure is released from tank, the fill cap will be able to be removed.

Steam flow is erratic/sputtering?

A small blockage caused by dirt or other foreign substance may be preventing the smooth flow of steam. Clean tank as described on page 8.

Is using boiled water from my tea kettle a good idea?

No, boiled water concentrates the minerals that form lime scale. Never use pre-boiled water in the DynaSteam.

Can I leave water in the DynaSteam?

No, water left in the boiler for a prolonged period may deteriorate the mechanics of the DynaSteam. Never leave water in the DynaSteam, always empty after using.

If you have hard water/high mineral content in your tap water, we recommend using distilled water to extend the life and enhance the performance of your DynaSteam.

How do I attach the accessories?

Push Green Button Down and Slide on Extension Wands / Accessories. Make sure button pops up to Lock accessory in position before using.

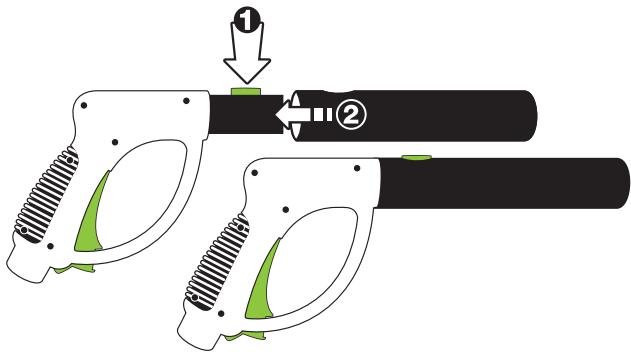

TROUBLESHOOTING

Unit does not heat up. (Power Switch does not illuminate with switch in ON position)	1 - Unit is not plugged in	1 - Check plug/outlet
	2 - Unit is damaged	2 - Unplug and contact DynaSteam support
Unit does not heat up. (Power Switch illuminates while in ON position)	1 - DynaSteam Is Empty	1 - Add water per instructions on page 3
	2 - Mineral has built up in the water tank	2 - Clean tank per instructions on page 6
	3 - Unit is damaged	3 - Unplug and contact DynaSteam support
Steam flow is erratic or sputtering.	1 - Water level is low	1 - Add water per instructions on page 3
	2 - Steam hose has become twisted/kinked	2 - Untwist hose
	3 - Mineral has built up in the water tank	3 - Clean tank per instructions on page 6
Water comes out of the nozzle instead of steam.	1 - Steam has condensed in the hose line	1 - Point nozzle in bucket and discharge
	2 - Water has not become hot enough	2 - Wait for steam pressure to build
	3 - Water tank is over-filled	3 - Turn power off, allow unit to cool, and empty some water out of tank.
The DynaSteam generates a large amount of steam which can condense into water in the hose, tools, or nozzle and accumulate after a period of cooling/non-use. A small amount of water will be discharged before steam resumes. This is normal, and the excess water can be quickly released into a bucket if the water is undesired.		
Tips will not stay connected on the extender wands.	1 - Tip not fully seated on wand button	1 - Make sure spring button is fully engaged through hole in tool tip.

COMPONENTS

- 1 ..... Steam Handle
- 2 ..... Steam Release Trigger
- 3 ..... Steam Lock
- 4 ..... Steam Hose
- 5 ..... Pressure Cap
- 6 ..... Pressure Gauge
- 7 ..... Triple Root Spike
- 8 ..... Speed Cone Tip
- 9 ..... Power Jet Tip
- 10 ..... Measuring Cup
- 11 ..... Funnel
- 12 ..... Wand Holder
- 13 ..... Carry Handle
- 14 ..... Power ON/OFF Switch
- 15 ..... Heat Light
- 16 ..... Extension Wands

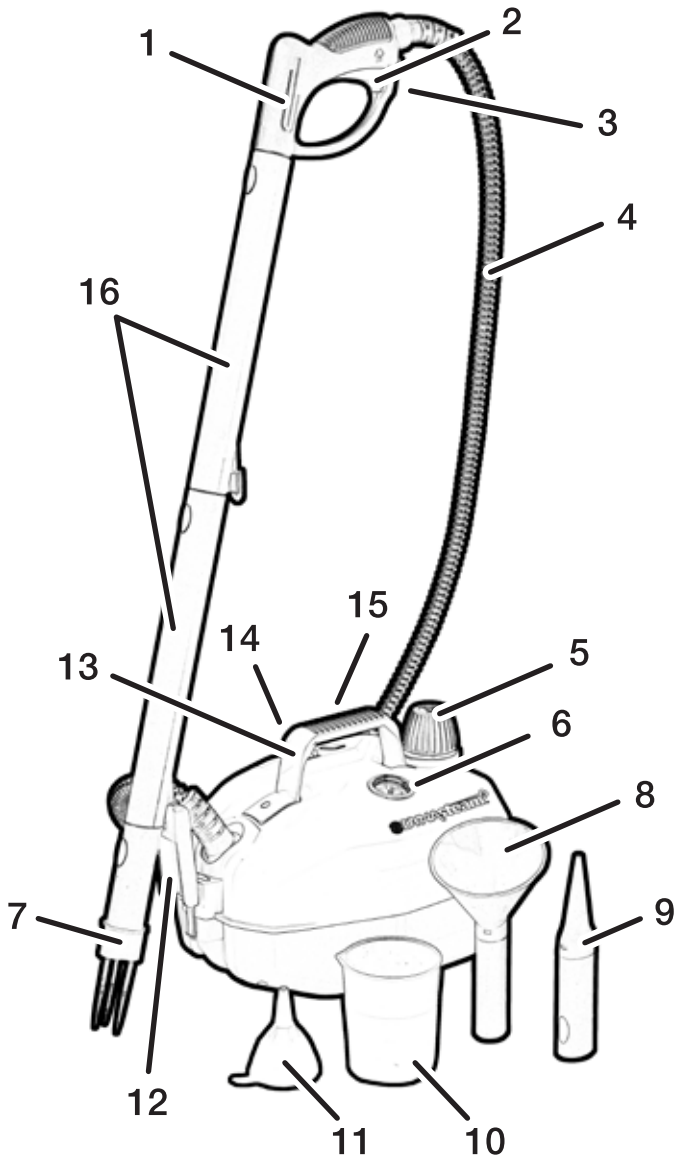

For replacement parts and accessories contact your authorized DynaSteam retailer or visit [dynasteam.com](http://dynasteam.com)

support@dynasteam.com  
1-877-403-8727

AVAILABLE OPTIONAL ACCESSORIES

- 17 ..... Wallpaper Remover
- 18 ..... Floor Scrub Brush
- 19 ..... Floor Scrub Brush Adapter
- 20 ..... Floor Scrub Brush Cleaning Cloth
- 21 ..... Steam Squeegee
- 22 ..... Small Tip Adapter
- 23 ..... Round Bristle Brush - Large
- 24 ..... Round Bristle Brush - Small
- 25 ..... Power Jet Tip - Angled

## STORAGE

Always empty your DynaSteam after using. Never leave water in the tank while in storage. Follow the procedure below after using.

**1**

Turn off and unplug DynaSteam.

**2**

Release all remaining steam in tank by squeezing the Steam Release Trigger. Trigger can locked open by engaging the Trigger Lock in the ON position.

**3**

Allow unit to fully discharge steam and completely cool for 20 minutes or more.

**4**

After cooling, release Trigger Lock and remove wand accessories.

**5**

Empty all remaining water from the tank by tipping unit on end. Never allow water to remain in tank when not being used or in storage.

**6**

Replace pressure cap and store in a safe, dry location.



**WARNING:** Do not expose DynaSteam to freezing temperatures.

## LIMITED WARRANTY

DYNAMIC warrants to the original purchaser that this product is free from defective materials and workmanship. This warranty is limited to remedy any defective part for a period of one year from date of original date of purchase. Retain your original receipt as proof of purchase. This warranty does not apply to, in our judgment, misuse or abuse. If this unit has been altered, no warranty is in force. This warranty does not apply if this unit is purchased outside the United States, Canada and Mexico. In no case shall DYNAMIC be liable for any accidental, punitive, consequential, or any other damages of any kind for breach of this or any other warranty, expressed or implied, whatsoever. Some states do not allow limitation on how long an implied warranty lasts, so the above limitation or exclusion may not apply to you. This warranty gives you specific legal rights, and you may also have other rights that vary from state to state.

**REGISTER ONLINE AT:** [www.dynasteam.com/registration](http://www.dynasteam.com/registration)

*To obtain warranty service during the warranty period, send the defective product postage pre-paid, along with proof of purchase showing date of purchase to the address below.*

Dynamic Solutions Worldwide, LLC  
12247 W. Fairview Ave. Milwaukee, WI 53226  
Attn: Service Department

## DO YOU HAVE HARD WATER?

If your water source contains high mineral content we recommend using distilled or de-mineralized water in your DynaSteam. If you must use water with a high mineral content, we recommend following the cleaning process below.

## HOW CAN I CLEAN THE WATER TANK?

To clean your water tank and remove mineral build-up, follow the procedure below.

**Do not use detergent for cleaning the tank.**

**1**

Mix a 50/50 solution of 8 oz. Vinegar with 8 oz. of Water in the measuring cup.

**2**

Pour the solution into a cool/unheated tank using the funnel.

**3**

Let solution soak in tank for approximately 30 minutes.

**4**

After 30 minutes, empty the solution from the tank.

**5**

Pour the solution into a cool/unheated tank using the funnel.

**6**

Repeat steps 1 thru 5 if necessary.

**7**

Replace pressure cap and store in a safe, dry location.



**WARNING:** Never clean the water tank while hot.

Always turn power off and unplug your DynaSteam before cleaning.



**Dynamic Solutions Worldwide, LLC**

12247 W. Fairview Ave.  
Milwaukee, WI 53226

support@dynasteam.com  
1-877-403-8727  
[www.dynasteam.com](http://www.dynasteam.com)